



PHILIPS

GERÄTEHANDBUCH BAND III

BEBILDERTE ERSATZTEILLISTE

**RACK
MT-4620
VOM
VHF-SYSTEM
VRC-4622**

1. ALLGEMEINES

2. ERSATZTEILLISTE

3. ÜBERSETZUNGSLISTE
ENGLISCH/DEUTSCH

RACK, ELECTRICAL EQUIPMENT
MT-4620

9551 690 59300

REPAIR PARTS LIST

NOVEMBER 1986

MANUAL No.

HGT5-2127e



© HOLLANDSE SIGNAALAPPARATEN B.V., 1986
- THIS INFORMATION CARRIER CONTAINS
PROPRIETARY INFORMATION WHICH MAY NOT
BE USED FOR OTHER PURPOSES THAN THOSE
FOR WHICH IT HAS BEEN RELEASED, NOR
BE REPRODUCED OR DISCLOSED TO THIRD
PARTIES, WITHOUT THE PRIOR WRITTEN
CONSENT OF HOLLANDSE SIGNAALAPPARATEN
B.V., THE NETHERLANDS.

Repair parts List MT-4620

PREFACE

1) General

This manual is a list of items authorized for operator (first echelon) organizational (second echelon), field (third echelon) and depot (fourth and fifth echelon) maintenance.

The fastening material of a repair part is listed directly below this repair part and the quantities of this fastening material are given for one repair part only. Fastening material for parts which are not repair parts, are listed as the maintenance repair parts mentioned above.

2) Explanation of columns

Column 1 lists the NATO stocknumber of the item

Column 2 lists the Manufacturing Code Number of the item

Column 3 lists the official name of the item and any additional description required for supply operations

Column 4 lists the quantities of the item, used in the next higher assembly of this item.

Unless otherwise indicated, the quantities are given in pieces.

Column 5 lists the echelon which is authorized to make a request for the item.

Column 6 lists the number of the figure, which shows the location of the item.

Column 7 lists the key number of the item on the figure, mentioned in column 6.

Repair parts List MT-4620

3) Abbreviations

The abbreviations listed below may appear in the manual.

br	brass
cd-pltd	cadmium plated
cr	chromium
corr-res-s	corrosion-resistant steel
fl-fil-hd	flat fillister head
fl-hd	flat head
id	inside diameter
l	length
ni	nickel
ni-pltd	nickel-plated
od	outside diameter
p-bz	phosphor bronze
s	steel
spg-s	spring-steel
thk	thick

Repair parts List MT-4620

RACK, ELECTRICAL EQUIPMENT MT-4620 type 9551 690 59300

This equipment consists of the following subassemblies:

RACK, ELECTRICAL EQUIPMENT MT-4620 page 4

LIST OF FIGURES MT-4620 page 18

Repair parts List MT-4620

Line No.	NAVO Stocknumber	Mfg. Code No.	Description	Qua	Ech	Fig No	Key No	Remarks
	1	2	3	4	5	6	7	8
1	5820-17-052-4057	9551 690 59300	RACK, ELECTRICAL EQUIPMENT MT-4620 consisting of the following spare parts:	2	2	1	8	
2	5340-17-033-1512	3522 105 42040	BLOCK; cr-ni-s; to guide stacked units	2	2	1	8	
3		2522 401 09011	<u>secured with:</u> NUT, HEXAGON; corr-res-s; type M 4 NEN 1560	2	2			
4	5305-12-151-7786	2522 001 17172	SCREW, FL-FIL-HD; corr-res-s; type AM 4 x 12 NEN 1602	2	2			
5	5310-17-033-6249	2522 613 03009	WASHER, LOCK; p-bz ni-pltd; type B 4,1 NEN 1197	2	2			
6	5340-17-033-0219	3522 114 09100	BLOCK; cr-ni-s; to guide stacked units	2	2	1	7	
7		2522 401 09011	<u>secured with:</u> NUT, HEXAGON; corr-res-s; type M 4 NEN 1560	2	2			
8	5305-12-151-7786	2522 001 17172	SCREW, FL-FIL-HD; corr-res-s; type AM 4 x 12 NEN 1602	2	2			
9	5310-17-033-6249	2522 613 03009	WASHER, LOCK; p-bz ni-pltd; type B 4,1 NEN 1197	2	2			

Repair parts List MT-4620

Line No.	NATO Stocknumber	Mfg. Code No.	Description	Qua	Ech	Fig No	Key No	Remarks
	1	2	3	4	5	6	7	8
			<u>RACK, ELECTRICAL EQUIPMENT</u> (continued)					
1		3522 154 57500	CLAMP; cr-ni-s; to secure stacked units	1	2	1	4	
2		2522 401 09012	<u>secured with:</u> NUT, HEXAGON; corr-res-s; type M 5 NEN 1560	2	2			
3	5315-17-036-0922	3522 114 19700	PIN, SHOULDER, HEADLESS; cr-ni-s	2	2	1	3	
4	5340-17-033-0203	3522 154 01200	POST, ELECTRICAL-MECHANICAL EQUIPMENT; consisting of stud, washer and nut.	1	2	1	2	
5		2522 634 10006	RING, RETAINING; corr-res-s; type 3,2 DIN 6799	2	2	1	5	
6	5310-17-036-0197	2522 613 03012	WASHER, LOCK; p-bz ni-pltd; type B 5,1 NEN 1197	2	2			
7	5995-17-033-7450	3522 154 08700	LEAD, ELECTRICAL	1	3	1	9	
8	5310-17-007-4480	2522 405 01011	<u>secured with:</u> NUT, HEXAGON; br ni-pltd; type M 4 NEN 1560	2	3			
9	5305-17-003-5379	2522 001 01872	SCREW, FL-FIL-HD; br ni-pltd; type AM 4 x 12 NEN 1602	1	3			
10		2522 187 21093	SCREW, FL-HD; corr-res-s; type AM 4 x 6 NEN 2329	1	3			

Repair parts List MT-4620

Line No.	NATO Stocknumber	Mfg. Code No.	Description	Qua	Ech	Fig No	Key No	Remarks
	1	2	3	4	5	6	7	8
			<u>PACK, ELECTRICAL EQUIPMENT</u> (continued)					
1	5310-17-033-6249	2522 613 03009	WASHER, LOCK; p-bz ni-pltd; type B 4,1 NEN 1197	2	3			
2	5340-12-149-9099	2622 890 11004	MOUNT, RESILIENT <u>secured with:</u>	4	4	1	11	
3		2522 401 09012	NUT, HEXAGON; corr-res-s;	4	4			
4		2522 187 21115	type M 5 NEN 1560 SCREW, FL-HD; corr-res-s;	4	4			
5	5310-17-036-0197	2522 613 03012	type AM 5 x 12 NEN 2339 WASHER, LOCK; p-bz ni-pltd;	4	4			
6	5340-17-036-0921	3522 114 19600	type B 5,1 NEN 1197 <u>secured with:</u>	2	3	1	1	
7		2522 001 17098	SCREW, FL-FIL-HD; corr-res-s;	1	3			
8	5310-17-015-5052	2522 613 03005	type AM 3 x 8 NEN 1602 WASHER, LOCK; p-bz ni-pltd;	1	3			
9	5820-17-033-7214	3522 143 07960	type B 3,1 NEN 1197 PLATE, METAL; bottom	1	4	1	12	

Repair parts List MT-4620

Line No.	NATO Stocknumber	Mfg. Code No.	Description	Qua	Ech	Fig No	Key No	Remarks
	1	2	3	4	5	6	7	8
			<u>RACK, ELECTRICAL EQUIPMENT</u> (continued)					
1	5820-17-033-7216	3522 114 19900	PLATE, METAL; top	1	4	1	6	
2		2522 032 30231	<u>secured with:</u> BOLT, HEXAGON; corr-res-s; type M 6 x 20 DIN 933	4	4			
3		2522 600 27036	WASHER, FLAT; corr-res-s; type B 6,1 NEN 1197	4	4			
4		2522 608 05002	RING, ELECTRICAL BONDING; corr-res-s; 8 mm od, 4,3 mm id, 0,8 mm thk	2	3	1	10	
5	5305-17-033-7797	3522 154 08800	SCREW, WING; cr-ni-s; M8 thread 1 9 mm, shank 1 31 mm	4	2	1	13	
6	5310-17-045-2992	3522 114 19500	<u>secured with:</u> NUT, ROUND; cr-ni-s; M8	1	2			
7	5310-17-036-0199	2522 613 03017	WASHER, LOCK; p-bz ni-pltd; type B 8,1 NEN 1197	1	2			
8	5310-17-053-1511	2522 600 27017	WASHER, FLAT; corr-res-s; type M 3	2	3	1	14	

Repair parts List MT-4620

List of Figures MT-4620

Fig. 1 RACK, ELECTRICAL EQUIPMENT MT-4620 (exploded
view)

Repair parts list MT-4620

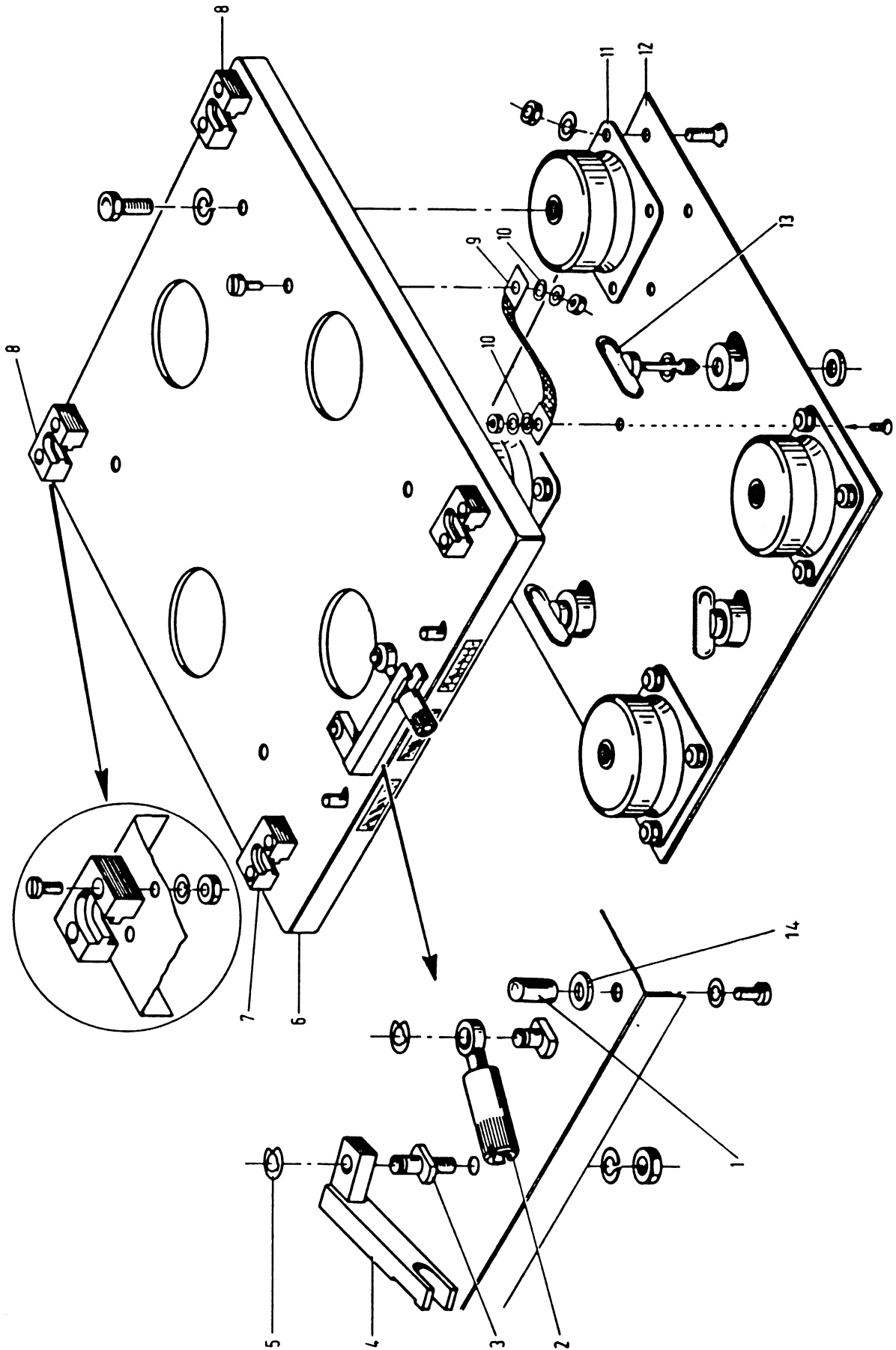

Fig.1. Rack, electrical equipment MT-4620 — exploded view

RACK	- GESTELL
Translation	- Übersetzung
Block	- Block
Bolt, Hexagon	- Bolzen, Sechskant
Brass	- Messing
Cadmium Plated	- Cadmiert
Chromium	- Chrom
Clamp	- Klemme
Corrosion-Resistant Steel	- Korrosionsbeständiger Stahl
Description	- Beschreibung
Flat Fillister Head	- Zylinder-Flachkopf
Flat Head	- Flachkopf
Inside Diameter	- Innendurchmesser
Lead. Electrical	- Masseband
Length	- Länge
Line No. (Line Number)	- Zeile
List Of Figures	- Bildtafelübersicht
Mfg. Code No.	- Teilekennzeichen
Mount. Resilient	- Dämpfungslager
NATO Stocknumber	- Versorgungsnummer
Nickel	- Nickel
Nickel-Plated	- Vernickelt
Nut, Hexagon	- Mutter, Sechskant
Nut, Round	- Mutter, Rund
Outside-Diameter:	- Außendurchmesser
Phosphor Bronze	- Phosphorbronze
Pin	- Stift
Pin, Shoulder, Headless	- Bolzen mit Ansatz
Plate, Metal	- Metallplatte
Post, Electrical-Mechanical Equipment	- Verriegelung
Quantity	- Menge
Rack, Electrical Equipment	- Gestell
Ring, Electrical Bonding	- Ring, Erdleitung
Ring, Retaining	- Sprengring
Screw	- Schraube
Screw, Wing	- Flügelschraube
Secured With	- Befestigt mit
Spring-Steel	- Federstahl
Steel	- Stahl
Thick	- Dicke
Washer, Flat	- Unterlegscheibe
Washer, Lock	- Zahnscheibe